

Omnican® fine Comfort

PEN NEEDLES FOR INSULIN INJECTION COMBINED WITH A SHARPS COLLECTOR IN ONE BOX



Omnican® fine pen needles –

pick a pen needle from the expert

Every single part of this pen needle has been designed and manufactured for maximum precision and comfort. A small device with many features – that together makes a big difference in injection comfort.



2 in 1

Omnican® fine box – be on the safe side

Using the medical sharps collector Omnican® fine box means you never have to touch the needle again after usage. This provides additional protection against needle-stick injuries.



Virtually pain-free penetration

Extremely fine three-facet grinding minimizes tissue trauma. Special silicone finish for a smooth gliding and virtually pain-free penetration of skin and tissue.



Optimized insulin flow

Extra-thin-wall technology allows for a larger inner diameter and an optimized insulin flow. Less force is required, and injection time is reduced.

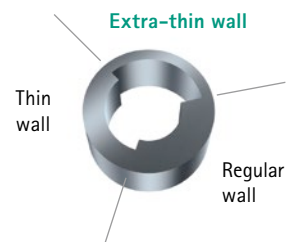

Needle length	Ø	Technology	Sales unit	REF
4 mm	31G 0.25 mm	○ Extra-thin wall	100 pcs.	9167846SE
6 mm	31G 0.25 mm	○ Extra-thin wall	100 pcs.	9167668SE
8 mm	31G 0.25 mm	○ Extra-thin wall	100 pcs.	9167684SE
12 mm	29G 0.33 mm	● Thin wall	100 pcs.	9167641SE

50
YEARS
EXPERTISE
CANNULAS

20
YEARS OF
EXPERTISE
DIABETES

Product includes 100 pen needles and a medical sharps collector. Sharps collector fulfills the tightened requirements according to EN ISO 23907:2012.

Omnican® fine

HOW TO USE THE PEN NEEDLE



Remove peel paper.



Place needle onto injection device. Keep straight.

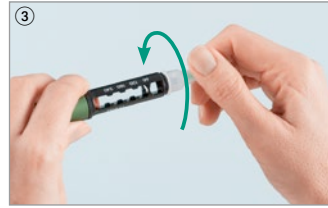

Screw needle onto injection device. Ensure a tight fit.



Remove needle container.



Pull needle shield off without tilting it.



Check functionality according to instructions for use of injection device.



Dial and inject according to instructions for use of injection device. After the injection, leave the needle in the fatty tissue for about 10 seconds. This prevents leakage.



Insert the used pen needle without tilting it into the screw-off mechanism of the medical sharps collector Omnican® box. While screwing off the needle, apply slight vertical pressure on the pen to ensure safe disposal.



STAY ON THE SAFE SIDE

Pen needles are sterile single-use products. Multiple use reduces quality and safety. Change the pen needle after every injection! Discard used pen needles into a sharps bin.

TECHNICAL DATA

Material needle tube	Stainless steel with a silicone finish
Needle hub	Polypropylene
Needle container	Polyethylene
Glue	UV-curable adhesive
Needle shield	Styrene-butadiene copolymer
Nontoxic/hypoallergenic	DEHP-free, BPA-free, PVC-free and latex-free, non-pyrogenic.
Wall thickness needle tube	4–8 mm: extra-thin wall (min. 0.146 mm) 12 mm: thin wall (min. 0.190 mm) according to ISO 9626
Sales unit	100 Omnican® fine pen needles in a dispenser box. Omnican® fine Comfort: 100 Omnican® fine pen needles plus a sharps container in one sales unit.
Shelf life	5 years (60 months)
Sterilization	Ethylene oxide (EO)
Production facility certificate	EN ISO 13485
Product standards	EN ISO 11608-2
Product classification	Medical device according to MDD 93/42/EEC, class IIa

COMPATIBILITY



Omnican® fine pen needles fit a high variety of injection systems, in accordance with ISO 11608-2.

Further information:
www.bbraun.com/diabetes-pencompatibility

The brands listed below are the property of the named companies.

Berlin-Chemie	BerliPen® areo 2, BerliPen® Junior, BerliPen® Precision
BMS AstraZeneca	Byetta® (BMS = Bristol-Myers Squibb)
Lilly	HumaPen® Luxura, HumaPen® Luxura HD, HumaPen® Memoir, HumaPen® Savvio, KwikPen™
Novo Nordisk	FlexPen®, FlexTouch®, NovoPen® 4, NovoPen® 5, NovoPen Echo®, NovoPen® Junior, Victoza®
Owen Mumford	Autopen® 24, Autopen® Classic 1, Autopen® Classic 2
Sanofi	ClikStar®, Lyxumia®, SoloStar®, TactiPen®
Ypsomed	ServoPen®, YpsoPen®